



## 12LS-100

12 V 107 Ah

Design lifetime: 10 years



Q-Batteries 12LS-100 is an AGM battery, which is designed for standby applications such as fire-detecting-systems, UPS or burglar-systems.

### Application:

UPS, security- and telecommunicationsystems etc.



### Specification:

Voltage Per Unit	12 V		
Capacity	107 Ah	@20hr-rate to 1.8V per cell @25°C	
Cells Per Unit	6		
Weight	ca. 29.5 kg +/- 3%		
Max. Discharge Current	1.000 A (5 sec.)		
Internal Resistance	ca. 4.5m $\Omega$		
Operating Temperature Range Normal	Discharge: - 15°C – 50°C	Charge: -10°C – 50°C	Storage: - 20°C – 50°C
Operating Temperature Range	25°C $\pm$ 5°C		
Self Discharge	Valve Regulated Lead Acid (VRLA) batteries can be stored for more than 6 months at 25°C. Self-discharge ratio less than 3% per month at 25°C. Please charge batteries before using.		
Terminal	F12 (M8 bolt)		
Container Material	A.B.S. (UL94-HB)		

### Dimensions:

328 Length x 172 Width x 233 mm Height

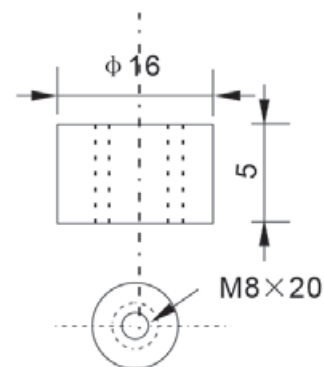
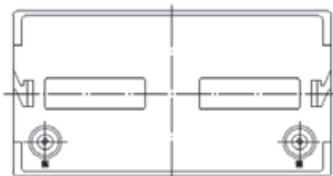
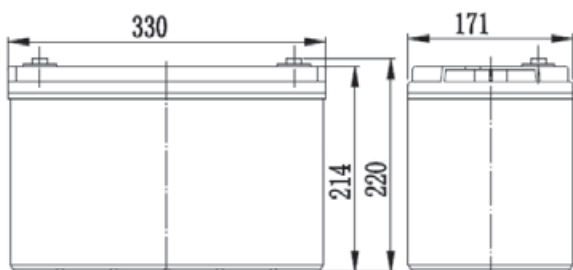

## Constant current discharge characteristics: A (25°C)

FV/Time	10 Min.	15 Min.	30 Min.	1 HR	2 HR	3 HR	4 HR	5 HR	8 HR	10 HR	20 HR
9.60 V	218	168	101	61,8	36,5	26,3	21,0	18,0	12,3	10,2	5,40
9.90 V	211	164	98,5	60,9	36,3	26,2	20,9	17,8	12,3	10,2	5,38
10.2 V	203	158	95,5	59,3	36,0	26,0	20,7	17,7	12,2	10,1	5,37
10.5 V	194	153	93,2	57,5	35,5	25,8	20,6	17,6	12,1	10,1	5,34
10.8 V	183	144	89,7	55,6	34,6	25,0	20,0	17,1	11,7	10,0	5,30

## Constant current discharge characteristics: Watt (25°C)

FV/Time	10 Min.	15 Min.	30 Min.	1 HR	2 HR	3 HR	4 HR	5 HR	8 HR	10 HR	20 HR
9.60 V	2354	1845	1128	705	423	309	247	212	147	122	64,7
9.90 V	2284	1800	1105	694	421	308	246	211	146	121	64,6
10.2 V	2190	1734	1071	676	417	306	244	209	145	121	64,4
10.5 V	2095	1675	1045	655	411	303	242	208	144	120	64,0
10.8 V	1978	1586	1007	634	400	294	235	202	139	119	63,6

## Storage characteristic:

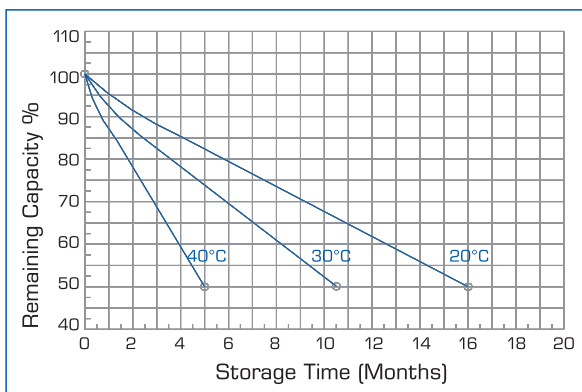

## Charging Method:

Recharge after use, at least every 6th month:

Cyclic charging voltage  
14,5 to 14,9 V (25°C)

Float charging voltage (25°C)  
13,5 to 13,8 V (25°C)

Maximum charging current  
30A

Do not short circuit the battery.

## Capacity Factors with different Temperature:

Battery Type		-20°C	-10°C	0°C	5°C	10°C	20°C	25°C	30°C	40°C	45°C
GEL Battery	6V & 12V	50%	70%	83%	85%	90%	98%	100%	102%	104%	105%
	2V	60%	75%	85%	88%	92%	99%	100%	103%	105%	106%
AGM Battery	6V & 12V	46%	66%	76%	83%	90%	98%	100%	103%	107%	109%
	2V	55%	70%	80%	85%	92%	99%	100%	104%	108%	110%